



OPERATOR, MAINTENANCE & PARTS MANUAL

Post Hole Digger

PHD-SC



1/29 MUSTANG DRIVE, RUTHERFORD NSW 2320
PO BOX 454, RUTHERFORD NSW 2320
T. 61 2 4932 3011 / F. 61 2 4932 1088
INFO@SXM.COM.AU / WWW.SXM.COM.AU

SOUTHERN CROSS MOWERS PTY LTD
T/A SOUTHERN CROSS AG MACHINERY
ABN 54 062 931 775



fb.me/SouthernCrossAg



TABLE OF CONTENTS

Introduction.....	01
Safety	
• Safety Instructions.....	02
• General Safety Guidelines.....	03
• Employer / Controller Responsibilities.....	04
• Supervision, Instruction and Training.....	04
• Inspection, Maintenance and Repair.....	04
• Service and Maintenance Safety.....	04
• Start-Up Safety.....	05
• Operation.....	05
• Operation Safety.....	05
• Personal Protective Equipment (PPE).....	05
• Storage and Transport.....	05
• Storage Safety.....	05
• Transport Safety.....	05
• Modifications.....	06
• Safety Signs.....	06
• Installation of Safety Signs.....	06
Assembly Instructions (Step 1-7).....	07
• Step 8 PTO Shaft First Fitting.....	10
Prior to Operation.....	11
Preparation	12
Starting and Stopping Safety.....	12
Transportation Safety.....	14
Attaching to Tractor.....	15
Operating Instructions.....	15
Preoperational Adjustments.....	15
Maintenance Safety.....	16
Storage Safety.....	16
Safety Decal Locations.....	17
Post Hole Digger Safety Decals.....	18
Maintenance Schedule.....	20
Troubleshooting Guide.....	21
For Further Information.....	24
Post Hole Digger Parts Diagram.....	25
Post Hole Digger Parts List.....	26
.....	26
Warranty & Register Your Warranty.....	28
Warranty Process.....	29

**WARNING**

READ THE OPERATOR, MAINTENANCE AND PARTS MANUAL BEFORE USING THE POST HOLE DIGGER.

INTRODUCTION

Southern Cross Ag Machinery Post Hole Diggers are supplied with a six and a twelve inch auger. Nine and fourteen inch augers are also available.

This manual contains valuable information about your new Post Hole Digger. It has been carefully prepared to give you helpful suggestions for operating, adjusting and servicing your Post Hole Digger. Keep this manual handy for frequent reference. All new operators or owners must review the manual before using the equipment and at least annually thereafter.

It is the owner's and/or operator's responsibility to;

- Read and understand the information contained in this manual.
- Operate, lubricate, assemble and maintain the equipment in accordance with all instructions and safety procedures in this manual.
- Inspect the equipment and replace or repair any parts that are damaged or worn which could cause damage, wear to other parts, or cause a safety hazard.

Please contact your Southern Cross Ag Machinery Dealer if you need any further assistance with your Post Hole Digger or additional copies of the manual. Visit our website www.sxm.com.au for a complete list of dealers in your area. You can also download additional copies of this manual from our website.

SAFETY

Safety Instructions

Southern Cross Ag Machinery encourages good safety practices. Good safety practices not only protect you but also the people around you. Please ensure that everyone using this equipment is familiar with the recommended operating and maintenance procedures, has read and understood the Operators Manual and follows all the safety precautions. Most accidents can be prevented. Do not risk serious injury or death by ignoring good safety practices.

The alert symbol is used throughout this manual and on the product safety decals. This symbol indicates attention is required and identifies hazards concerning your personal safety and the safety of others. Please follow the recommended precautions.



The safety alert symbol means...
ATTENTION! BECOME ALERT! YOUR SAFETY IS INVOLVED!



CAUTION

The Caution Symbol indicates a potentially hazardous situation that, if not avoided, may result in minor or moderate injury. It may also be used to alert against unsafe practices.



WARNING

The Warning Symbol indicates a potentially hazardous situation that, if not avoided, could result in death or serious injury and includes hazards that are exposed when guards are removed. It may also be used to alert against unsafe practices.



DANGER

The Danger Symbol indicates an imminently hazardous situation that, if not avoided will result in death or serious injury. This signal word is to be limited to the most extreme situations, typically for machine components that, for functional purposes, cannot be guarded.

SAFETY continued

General Safety Guidelines

- Have a first-aid kit available for use and know how to use it.
- Have a fire extinguisher available, stored in a highly visible location and know how to use it.
- Wear appropriate protective gear. This list may include but is not limited to:
 - hard hat
 - protective shoes with slip resistant soles and steel caps
 - protective glasses or goggles
 - heavy gloves
 - wet weather gear
 - hearing protection
 - respirator or filter mask
- Read and understand the Operator's Manual and all safety decals before operating, servicing, adjusting, repairing or hitching the equipment.
- Do not attempt any unauthorised modifications to your Southern Cross Ag Machinery product as this could affect function or safety and could affect the life of the equipment.
- Never start or operate the Post Hole Digger except from the operator's station on the power unit.
- Inspect and clean the working area before operating. Remove all obstructions such as rocks, stumps and wire.
- Keep hands, feet, clothing, and hair away from moving parts.
- Ensure bystanders are clear of the area before operating. A minimum distance of 100 metres should be kept from all bystanders when Post Hole Digger is in operation.
- Never operate this equipment while using alcoholic beverages or drugs that can hinder alertness or coordination. Consult your doctor about operating this machine while taking any medication.
- Under no circumstances should children under the age of 18 be allowed to work with or around this equipment. Do not allow anyone to operate or assemble this equipment until they have read and understood this manual.
- This equipment is dangerous to anyone unfamiliar with its operation. The operator should be responsible, properly qualified and physically able person familiar with farm machinery and competent in this equipments operation.
- All new operators or owners must review the manual before using the equipment and at least annually thereafter.
- In order to provide a clear view, certain illustrations in this manual may show an assembly with a safety guard removed equipment should never be operated in this condition. Keep all guards in place. If guard removal becomes necessary for repairs, reinstall the guards prior to use.
- Replace any safety decal that is not legible or is missing. The locations of such safety decals are indicated in this manual.
- Never exceed the limits of a piece of machinery. If its ability to do a job, or to do so safely, is in question – DON'T TRY IT.
- In addition to the design of this implement, safety decals and safety equipment, accident prevention is dependent upon the awareness, common sense, forethoughts, and proper training of everyone involved in the operation, transport, maintenance and storage of the machine. Also refer to safety messages and operating instructions in each of the appropriate sections of the tractor manual. Pay close attention to the safety decals affixed to the tractor and the Post Hole Digger.

SAFETY continued

Employer/Controller Responsibilities

OH&S legislation places obligations on the employer, or the controller of the Post Hole Digger, to identify the hazards and control the risks associated with the use of the Post Hole Digger in their workplace and to do so in accordance with the manufacturer's instructions.

When purchasing a Post Hole Digger:

- Ensure the manufacturer's instructions are provided at the point of purchase.
- Ensure the Post Hole Digger conforms to industry safety standards.
- Discuss your needs with the supplier, to ensure the Post Hole Digger is compatible with the power of your tractor and is appropriate for the intended application – consider the speed of your tractor's PTO and its compatibility with the Post Hole Digger's gearbox.
- Seek practical advice and instruction from the supplier on the use and limitations of the Post Hole Digger. If you are hiring, leasing or borrowing a Post Hole Digger on a temporary basis, get safe use instructions from the person supplying it.
- The employer must provide safety instructions to all those involved in using a Post Hole Digger.
- A copy of safety instructions must be kept in good condition with the Post Hole Digger.
- Generally, the safety instructions should be the manufacturer's instructions. Any variations from the manufacturer's instructions must be based on a risk assessment and must not remove any of the safety features nor expose anyone to risks.

Supervision, Instruction and Training

The employer must provide safe systems of work, adequate supervision, instruction and training to all those involved in using a Post Hole Digger. They must be instructed in the safe operation of the Post Hole Digger, including hazards specific to the workplace, including the terrain, stability of the tractor, working environment and the like. The employer should ensure that everyone achieves a level of understanding that enables them to safely and competently operate the Post Hole Digger.

Inspection, Maintenance and Repair

- The Post Hole Digger must be inspected according to the manufacturer's instructions, prior to use. See page 20 for Maintenance Instructions.
- All problems identified must be rectified, prior to use.
- The Post Hole Digger must be maintained according to the manufacturer's instructions.
- Replacement parts must be to the original manufacturer's specifications or their equivalent.
- Safety signs and decals should be legible, maintained and where necessary replaced.
- Repairs should be carried out by a competent person.
- When suspending the Post Hole Digger for maintenance or repair, whether attached to the tractor or suspended in another way, adequate safety stands must be used to prevent inadvertent lowering of the Post Hole Digger.

Service and Maintenance Safety

- Stop engine, set brake, remove ignition key and wait for all moving parts to stop before servicing, adjusting, repairing or unplugging.
- Support the equipment with blocks or safety stands before working beneath it.
- Follow good shop practices including:
 - keep service area clean and dry
 - be sure electrical outlets and tools are properly grounded
 - use adequate light for the job.
- Use only tools, jacks and hoists of sufficient capacity for the job.
- Replace and secure all shields removed during servicing before operating.
- Use heavy leather gloves to handle sharp objects.

SAFETY continued

Start-up Safety

- Do not let inexperienced operators or children use this equipment.
- Place all tractor and machine controls in neutral before starting.
- Operate only with Roll Over Protective System (ROPS) and seat belt equipped tractors.
- Do not operate inside a building unless there is adequate ventilation.
- Ensure all shields are in place and in good condition before operating.
- Stay clear of PTO shaft and machine when engaging PTO.

Operation

Prior to use, the Post Hole Digger should be inspected to ensure it is working correctly. All safety features must be included in this inspection. If any safety feature is not working correctly, the Post Hole Digger must not be used. The Post Hole Digger must be operated according to the manufacturer's instructions.

The operator must ensure that no-one is exposed to risks arising from the slashing operation.

Additional safety controls may be required when operating in the vicinity of people or traffic – e.g. alongside highways, roads or other public areas.

Where adjustable or removable guarding is provided for specific applications, such as vineyards and horticulture, and the guarding has been removed or is no longer effective, appropriate control measures must be implemented. These controls must ensure that the risk of injury is eliminated or controlled. Before using a Post Hole Digger in an application other than that outlined above, the guards must be readjusted or replaced so as to be effective.

Operation Safety

- Do not permit riders.
- Do not wear loose fitting clothing during operation.
- Never operate over 540 PTO rpm speed.
- Stay on tractor seat while operating Digger. Serious personal injury may result if any attempt is made to assist Digger operation by hand.
- Allow Digger to stop completely and disengage PTO from tractor before contracting the auger.
- Do not climb onto Digger or exert downward force manually.
- Do not operate PTO when the angle created between the earth and the drive shaft exceeds 45 degrees. If the PTO shaft breaks or the universal joint fails, causing the PTO to rotate without support at both ends, injury may result.
- Turn off tractor and remove key before working on Digger.
- Be sure auger is completely removed from hole before moving tractor.
- Before you operate the Digger, check all pins, bolts and connections to be sure all are securely in place.
- Never operate the equipment in the raised position.
- This Post Hole Digger was designed for one-man operation from the tractor seat. It is the responsibility of the operator to see that no one is within twenty-five feet (25') of the digger when it is started. Do not operate the digger with another person near, or in contact with, any part of the digger, PTO driveline, or auger. Serious personal injury or death may result if any attempt is made to assist digger operation by hand.
- Never place yourself between the tractor and digger while implement is in operation.
- Do not walk or work under a raised digger or attachment unless it is securely blocked or held in position. Do not depend on the tractor hydraulic system to hold the digger or attachment in place.

SAFETY continued

Operation Safety continued

- A heavy load can cause instability of the tractor. Use extreme care during travel. Slow down on turns and watch out for bumps. The tractor may need front counter-weights to counter-balance the weight of the digger.
- Consult Australian Association of Dial Before You Dig Services Ltd – www.1100.com.au Telephone. 1100 (for further contact information refer page 26) to make certain there are no buried gas lines, electrical cables, etc., in the work area before beginning operation.
- Use stabilizer bars, adjustable sway chains, or sway blocks on your tractor lift arms to keep the Post Hole Digger from swinging side to side. Adjust as tightly as practical for best performance.
- Never replace the shear bolt OR auger retaining bolt with any length other than what is specified in this manual. A longer, or protruding fastener is more likely to grab loose clothing or gloves which can result in serious injury or death.
- Do not operate digger on steep hillsides. When digging on uneven or hilly terrain, position the tractor with the Post Hole Digger uphill. With the Post Hole Digger downhill, the tractor could tip when attempting to pull the auger from its hole.
- Never position the auger point by hand or with any tool when the tractor is running.
- Never position the auger point by putting your hands on the auger, gearbox, boom, or driveline.
- Inspect the entire machine periodically as indicated in the Maintenance Section of this manual. Look for loose fasteners, worn or broken parts, pinched hydraulic hoses, and leaky or loose fittings. Make sure all pins have cotter pins and washers. Serious injury may occur from not maintaining this machine in good working order.
- To prevent rapid wear of U-Joints and possible failure of drivelines, never lift auger point more than 12" off the ground with PTO operating.
- To prevent possible instantaneous driveline failure, never move digger from hole-to-hole or transport while auger is rotating. This could lead to injury from flying pieces of the failed driveline.
- To prevent entanglement and possible serious injury or death, never use body weight to try to push auger into the ground.
- Worn edges or a slightly rounded point can seriously effect auger penetration. Check for wear before each use, replace as necessary.
- Do not shovel dirt away from a rotating auger as the shovel can be caught and thrown by the auger.

Personal Protective Equipment (PPE)

Prior to use, a risk assessment must be undertaken to determine the appropriate PPE required. Any identified PPE must be provided by the employer and must be used by those involved in the operation and maintenance of the Post Hole Digger. Examples of PPE are appropriate footwear and hearing & eye protection.

Storage and Transport

When not in use, the Post Hole Digger must be transported and stored according to the manufacturer's instructions. Requirements may differ when transporting a Post Hole Digger within a property and on a public road – you must comply with all statutory requirements. Always comply with all state and local lighting requirements when transporting on highways. Be sure the safety triangle is not blocked by the digger when transporting.

Storage Safety

- Store the unit in an area away from human activity.
- Do not permit children to play on or around the stored machine.
- Support the frame on stands and blocks to provide a secure base.

SAFETY continued



Transport Safety

- Review Transport Safety instructions in tractor manual before moving.
- Check with local authorities regarding transport on public roads. Obey all applicable laws and regulations.
- Make sure the SMV (Slow Moving Vehicle) emblem and all the lights and reflectors that are required by the local highway and transport authorities are in place, are clean, and can be seen clearly by all overtaking and oncoming traffic.
- Never have the equipment in operation during transport.
- Always travel at a safe speed.
- Turn curves or go up or down hills only at a low speed and at a gradual steering angle. Make certain that at least 20% of the tractor's weight is on the front wheels to maintain safe steering. Slow down on rough or uneven surfaces, and loose gravel.
- Use extreme care and maintain minimum ground speed when transporting on hillside, over rough ground and when operating close to ditches or fences. Be careful when turning sharp corners.

Modifications

A Post Hole Digger should not be modified or altered. However, if it is necessary to make modifications, they must be done by a competent person and based on a risk assessment. All modifications must comply with this industry safety standard.

Before any modifications are done, contact the manufacturer or supplier.

Anyone who undertakes modifications subsequently assumes the role and responsibilities of the designer and manufacturer. This does not include shortening a PTO shaft and cover when first installing the Post Hole Digger on a tractor (refer to page 10 for details).

The instructions relating to the Post Hole Digger and its use may need to be revised following a modification.

Any modifications made without manufacturers approval will void Warranty.

Safety Signs

- Refer pages 17-19 for the approximate location and detail of safety signs.
- Keep all safety signs clean and legible and replace any that are damaged or missing.
- When original parts are replaced, any safety signs affixed to those parts should be replaced as well. Replacement safety signs are available from your local dealer.

Installation of Safety Signs

- To install safety signs, ensure the installation area is clean and dry. Decide on the exact position before you remove the backing paper. Remove the smallest portion of the split backing paper and align over the specified area. Carefully press in place.
- Slowly peel back the remaining paper and smooth the remaining portion in place. Small air pockets can be pierced with a pin and smoothed out.



ASSEMBLY SAFETY INSTRUCTIONS

WARNING! Do not reach or place yourself under the equipment until it is locked securely.

WARNING! Be sure the safety shield over the PTO stub shaft on the gearbox and auger is not removed from the digger.

CAUTION! For safety, turn off the tractor before attaching the auger assembly to the gearbox. Remove the key to prevent the possibility of someone else starting the tractor.

DANGER! Never use any bolt longer than 3 1/2" to mount the auger assembly to the gearbox.

WARNING! When attaching PTO yoke to tractor's PTO shaft, be sure that they yoke is secured to the PTO shaft.

PRIOR TO OPERATION

- Check over all pins, bolts and connections to be sure all are securely in place.
- Nuts and bolts should be snugged with wrenches; cotter pins should be in place and bent over or flared out with pliers.
- The twist collar at the splined PTO union should be secure.
- The PTO shaft should be bolted and pinned with the roll pin at the gearbox.
- Replace any safety shields that may have been removed during installation.

ASSEMBLY INSTRUCTIONS

STEP 1

Check to be sure that you have received the complete Digger. There should be a gearbox, PTO Shaft, boom assembly, auger with cutting edges (to be sold separately) and tip plus a parts bag. In the parts bag there should be a PTO roll pin, shear bolt and nut, auger assembly bolts and nuts.

STEP 2

Lay out all of the parts for assembly. Attach the gearbox to the boom assembly with the clevis pin and insert cotter pin into the clevis pin. Attach tractor end of the boom assembly to the third point of the tractor. Make sure that the stabilizer arms on the tractor are in place. Now attach the U-frame assembly to the stabilizer arms on the tractor. With the pin in place raise the boom assembly and attach the U-frame assembly to the boom assembly by inserting bolt (3/4" x 2 3/4") through the ears of the U-frame assembly and the mounting plate on the boom assembly. Secure the bolt with locknut.

STEP 3

Check the clearance and reposition if necessary.

STEP 4

Use the tractor hydraulics to raise the Digger assembly to a height where the auger assembly can be attached. Use bolt and nut to attach auger assembly to the Digger.

STEP 5

Raise the Digger so that the auger is not touching the ground. Now insert PTO shaft onto tractor end. You should now connect the other end of the PTO shaft to the gearbox shaft and insert the shear bolt with locknut. Insert roll pin into PTO shaft yoke at the gearbox input shaft.

STEP 6

The Digger is now ready for use. The final adjustments can be made by trial and error.

ASSEMBLY INSTRUCTIONS continued

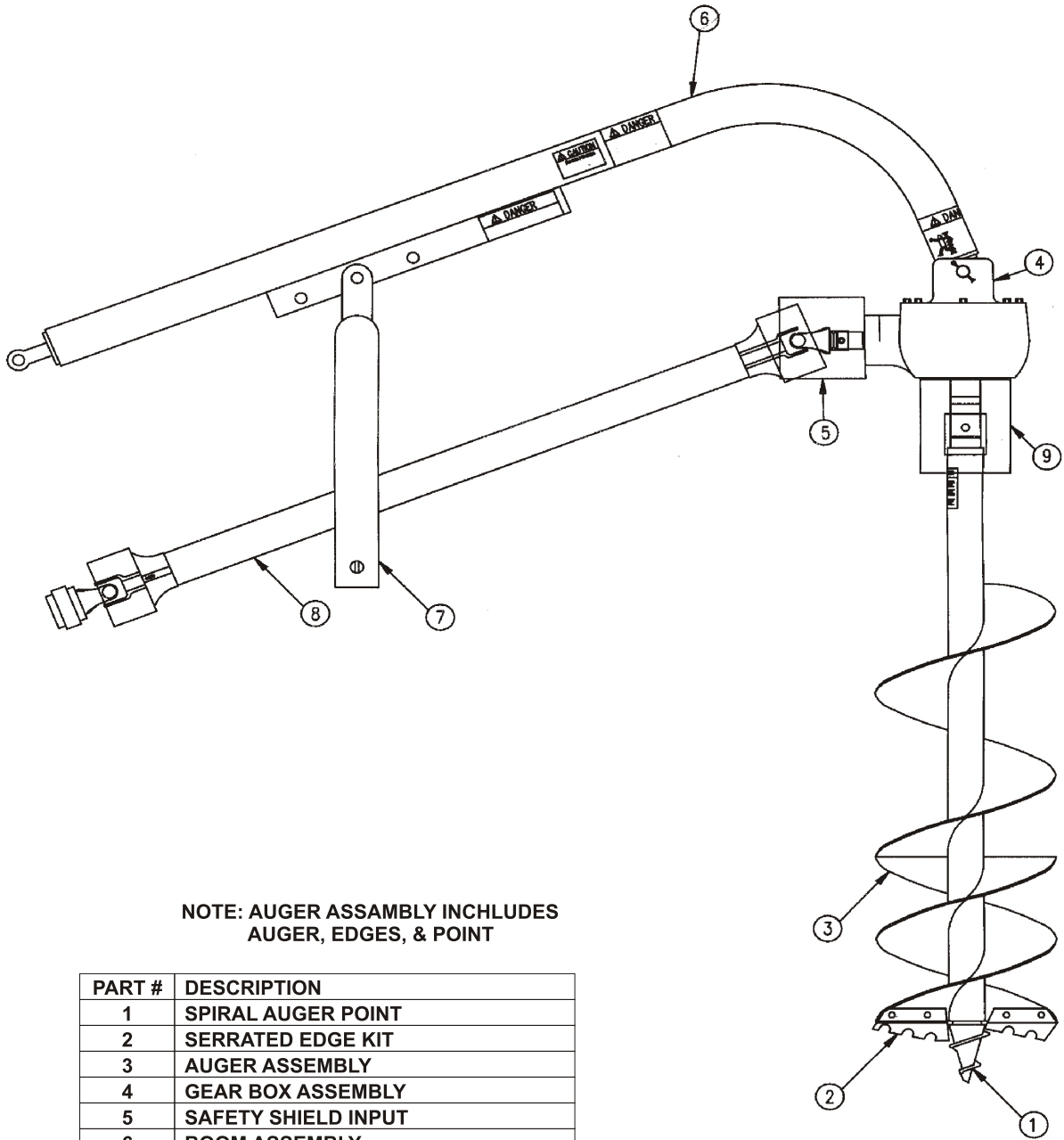

**NOTE: AUGER ASSAMBLY INCLUDES
AUGER, EDGES, & POINT**

PART #	DESCRIPTION
1	SPIRAL AUGER POINT
2	SERRATED EDGE KIT
3	AUGER ASSEMBLY
4	GEAR BOX ASSEMBLY
5	SAFETY SHIELD INPUT
6	BOOM ASSEMBLY
7	U-FRAME ASSEMBLY
8	PTO DRIVESHAFT
9	SAFETY SHIELD OUTPUT

ASSEMBLY INSTRUCTIONS continued

STEP 7 – PTO SHAFT FIRST FITTING

If tractor and Post Hole Digger have never been used together before, please follow the instructions below:

- a. Separate the inner and outer halves of the drive shaft.
- b. Attach the tractor end of the drive shaft to the tractor PTO output shaft and the Post Hole Digger half to the gearbox input shaft or slip clutch.
- c. With the Post Hole Digger in the operating position hold the shaft halves parallel to each other to check that the two sections of the drive shaft do not close completely nor extend to a point less than one third of the sliding section.
- d. Repeat Step (c) with Post Hole Digger in fully raised position.



WARNING!

Refer to *Maintenance Safety* (pg. 16) regarding working on or maintaining a Post Hole Digger when raised using the tractor three point linkage.

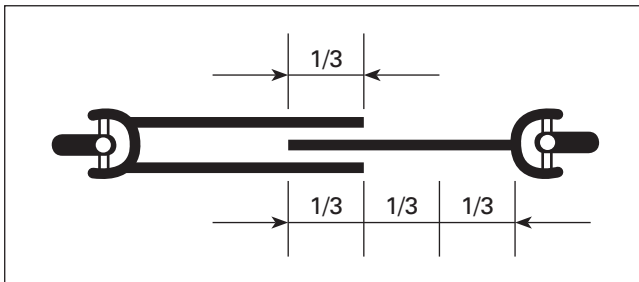

The diagram featured left shows the minimum engaged length for tri-lobal and 4-tooth style PTO shafts.

Note: Drawing unguarded schematic only. Never use a PTO shaft without approved safety guarding.

- e. If the PTO shaft is determined to be too long, cut equal amounts from both inner and outer half shafts and safety guards using a drop-saw or hacksaw. Remove any residual burrs or fillings from cutting and apply grease to both inner and outer shafts.
- f. If the PTO shaft is less than one third of the length of the engaged sliding section, please contact your dealer, as it may be necessary to replace with a longer drive shaft.

PRIOR TO OPERATION

BEFORE PUTTING Post Hole Digger INTO SERVICE IMPORTANT INSTRUCTIONS PRIOR TO OPERATING MUST BE FOLLOWED.

POST HOLE DIGGER SHIPPED WITHOUT OIL IN GEAR BOX AND WITHOUT GREASE IN GREASE FITTINGS. UNIT MUST BE SERVICED BEFORE USING.

Fill Gearbox using Multipurpose Gear Oil (85/140). For all Grease Fittings use a high-temp / multipurpose grease.

STEP 1

Place Post Hole Digger so that the deck is secure and level.

STEP 2

Remove the breather plug located at top of gearbox and plug / grub screw (located on the side or rear of the lower half of gearbox).

STEP 3

Fill gearbox using multipurpose gear oil through top fill hole until gear oil is level with lower hole.

STEP 4

Replace both the breather plug (located at top of gear box) and plug / grub screw (located at lower 1/2 of gearbox) and clean off any excess oil.

STEP 5

Grease the following points:

*Both Universal Joints and Safety Guard grease points on the PTO Shaft.

STEP 6

Inspect all guards to insure they are in good working order and properly secured. If not replace before using.

STEP 7

Check all bolts and nuts to insure they are tight and secure.

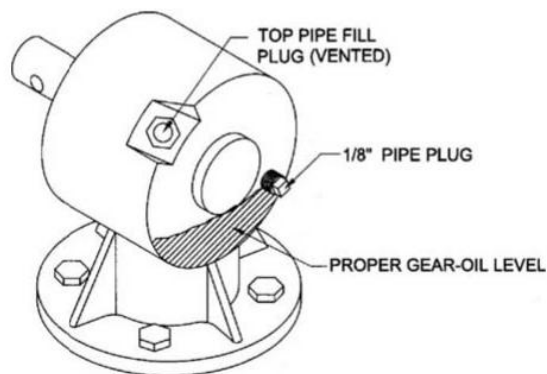

CAUTION

DO NOT overfill gearbox. This could cause damage to oil seals and can cause permanent damage to the gearbox. Any defects or failures caused by overfilling will not be covered under warranty

PREPARATION



Never operate the tractor and Post Hole Digger until you have read and completely understand this manual, the Tractor Operator's Manual and each of the messages found on the safety decals on the tractor and Post Hole Digger.

Personal protection equipment including hard hat, safety glasses, safety shoes, hearing protection and gloves are recommended during assembly, installation, operation, adjustment, maintenance, repairing, removal, or moving the implement. Do not wear loose fitting clothing or jewellery and be sure to contain long hair around equipment.

PROLONGED EXPOSURE TO LOUD NOISE MAY CAUSE PERMANENT HEARING LOSS! Tractors with or without Post Hole Diggers attached can often create enough noise to cause permanent hearing loss. We recommend that you use hearing protection at all times. Long-term exposure to noise levels over 80db can cause severe hearing loss.

NOTE: Hearing loss from loud noises (from tractors, chain-saws, radios, and other sources close to the ear) is cumulative over a lifetime, with no chance of natural recovery.

Always wear your seat belt. Serious injury or even death could result from falling off the tractor particularly during a rollover when the operator could be trapped under the ROPS or the tractor.

Clear area to be cut of stones, branches and other debris that might be thrown causing injury or damage.

Operate only in daylight.

Do not operate Post Hole Digger in dry conditions as there is a risk of starting fires.

Ensure Post Hole Digger is properly mounted, adjusted and in good operating condition.

Ensure that all safety guards and safety decals are properly installed and in good condition.

STARTING AND STOPPING SAFETY



Check the tractor master guard over the PTO shaft. Make sure it is in good condition and fastened securely to the tractor. Purchase a new guard if old guard is damaged or missing.

All tractors that are not equipped with a "live" Power Take Off (PTO) need to be equipped with an over-running PTO clutch. These are available through most farm machinery dealers.

NOTE: The addition of an over-running PTO clutch may change the length of the PTO driveline required. Pay extra attention to the instructions on the PTO driveline installation refer page 10. Be sure that the driveline system guarding is sufficient.

Post Hole Digger operating power is supplied from the tractor PTO. Refer to your tractor manual for PTO engagement and disengagement instructions. Know how to stop the tractor and Post Hole Digger quickly in case of an emergency.

The engine RPM should always be at idle speed when engaging the PTO. Once engaged and you are ready to start cutting, increase the PTO speed to approximately 540RPM and maintain throughout the cutting operation.

The use of this equipment is susceptible to certain hazards that cannot be protected against by mechanical means or product design. All operators of this equipment must read and understand this entire manual, paying particular attention to safety and operating instructions, prior to using.

Most accidents occur because of neglect or carelessness. Keep all assistants and bystanders one hundred metres from the operating Post Hole Digger. When machine is operated in populated areas where thrown objects could injure persons or property, operation must be stopped if anyone comes within one hundred metres.

The Post Hole Digger is designed for the use on tractors with 540-RPM power take off.

STARTING AND STOPPING SAFETY continued



Install and secure all guards and shields before starting or operating. The discharge chute, flaps, chains, driveline guards and tractor guards should be used and maintained in good working condition. They should be inspected carefully daily for missing or broken cables, chain links, shields and guards. Worn items must be replaced at once to reduce the possibility of injury.

Disengage Power Take Off (PTO) and place tractor transmission in neutral before attempting to start engine.

Many varied objects, such as wire, cable, rope or chains can become entangled in the working parts of the Post Hole Digger. These objects could then swing outside the housing at a greater velocity than the blades. Such an occurrence is extremely hazardous. Inspect the cutting area for such objects before slashing. Remove any objects from the site.

Never allow the cutting blade to contact objects. Cut higher first, allowing Post Hole Digger to clear such hidden objects. Never assume an area is clear. Always check!

Always stop the tractor, disengage PTO, allow cutter blades to come to a complete stop, lower implement to the ground, set park brake, shut off the tractor engine and remove the ignition key before dismounting tractor. Never leave equipment unattended while the tractor is running.

Never place hands or feet under Post Hole Digger. Stay clear of all moving parts.

Do not reach or place any part of your body under the equipment until it is blocked securely.

Do not allow riders on the Post Hole Digger or tractor at any time. There is no safe place for riders.

Do not operate unless all personnel, livestock and pets are at least one hundred metres away to prevent injury by thrown objects. Never direct the discharge chute towards anyone.

Never operate tractor and Post Hole Digger under trees with low hanging limbs. Operators can be knocked off the tractor and then be run over by the Post Hole Digger.

The rotating parts of this machine have been designed and tested for rugged use. However, they could fail upon impact with heavy, solid objects such as steel, concrete, rocks or stumps. To reduce the possibility of property damage, serious injury or even death never allow the cutting blades to come in contact with such objects.

Stop Post Hole Digger and tractor immediately upon striking an obstruction. Turn engine off, remove key, engage park brake then inspect and repair any damage before resuming operation.

Stay alert for uneven terrain, holes, roots and other hidden hazards. Keep away from drop-offs and hazards that could cause roll-over. Use extreme caution and maintain minimum ground speed when transporting or operating on hillsides, over rough ground and when operating close to ditches or fences. Be careful and slow down when turning sharp corners and changing direction on slopes. Do not start or stop suddenly on slopes and avoid operating on steep slopes. In extremely uneven terrain, rear wheel weights, front tractor weights and / or tire ballast should be used to improve stability.

Drive Post Hole Digger diagonally over sharp dips and avoid sharp drops to prevent tractor and Post Hole Digger from "hanging up." Always cut downward on slopes, never cut across the face. Always check tractor manual for proper use on slopes. Practice will improve your skills in manoeuvring on rough terrain.

TRANSPORT SAFETY



Always observe state and local laws governing highway safety and the travel of farm machinery on public roads.

When driving the tractor and equipment on roads or highways use flashing amber warning lights and a slow moving vehicle (SMV) identification emblem. Do not exceed 20kph. Reduce speed on rough roads and surfaces.

Plan your route to avoid heavy traffic.

Always install transport locks, pins or brackets before transporting.

Do not drink and drive.

Be a safe and courteous driver. Always yield to oncoming traffic in all circumstances, including narrow bridges, intersections etc. Watch for traffic when crossing or operating in close proximity to roadways.

Use extreme care and maintain minimum ground speed when operating close to ditches and or fences. Be careful when turning sharp corners.

Never allow riders on either tractor or Post Hole Digger.

ATTACHING TO TRACTOR



WARNING

Never stand between tractor and Post Hole Digger while backing the tractor up to the hitch

STEP 1

Attach to tractor's three point hitch as described in the Tractor's Operator's Manual.

STEP 2

Apply any multipurpose grease to the outside of the male (inner) PTO shaft section. Assemble PTO shaft and install on Post Hole Digger and tractor.

STEP 3

Pull shaft on the tractor side of the PTO shaft yoke to be sure it has locked in place. Make certain PTO shaft guards are in place and good working condition. Repeat this same process for the PTO shaft connection to the Post Hole Digger.



WARNING

Failure to install the retaining clip or quick coupler on the gearbox input shaft would allow the driveline to swing freely causing possible injury or death.

OPERATING INSTRUCTIONS

STEP 1

Move and Position. The Digger will hang in a approximate vertical position when raised clear of the ground, drive the tractor into position above the spot where you wish to dig.

STEP 2

Engage Drive. With the tractor engine idling at low RPM, engage the PTO.

STEP 3

Lower Digger. With the hydraulic power, lower the Digger and allow it to dig to a depth of about one foot.

STEP 4

Clear Auger. With the power still engaged and the auger turning, raise the boom to lift the auger out of the hole. This will clear the auger, depositing the earth around the hole.

STEP 5

Lower Digger. Lower the Digger again and allow it to dig another foot deeper. Then repeat the steps of boring and clearing until you have reached the desired depth.

PREOPERATIONAL ADJUSTMENTS

Set tractor's lift control stop at a position that will prevent the PTO shaft from coming in contact with the front edge of the Post Hole Digger when it is at full lift. Consult your tractor manual for instructions.

SPECIAL OPERATING CONDITIONS

Loose or Sandy Soil

In loose or sandy soil, you may get a cleaner hole if you stop the auger before lifting it from the hole and start it again as soon as it clears the hole. This will throw the soil out away from the hole.

Wet Clay / Obstacles

In wet clay, be careful not to let the auger dig too deep or it may get stuck. If you do get the auger stuck in wet clay or if it stalls against roots or stones, turn off the tractor.

DANGER



Keep clear of driveline until it stops completely. Entanglement will cause personal injury or death.

Remove PTO drive shaft from the gearbox. Turn the auger post counter clockwise with a large pipe wrench. One complete reverse turn will usually free the Digger.

Restart the tractor and lift slowly with the tractor hydraulics to free the auger from the ground. If the auger is still stuck, turn off the tractor and use a shovel to dig down and free the auger. Once the auger is free from the ground, reconnect the PTO drive shaft and you are ready to start digging holes again.

If the shear bolt has sheared, it will need to be replaced.

WARNING

Do not install a mounting bolt longer than 3 1/2". A longer mounting bolt will protrude on the turning auger possibly hitting the shield and causing a safety hazard.

(See cautions and instructions for shear protection in the Maintenance section of this manual.)

REMOVING DIGGER



Read all safety warnings and precautions on pages XX and XX of the manual, as well as the specific safety precautions below:

WARNING

Turn off the tractor and remove the key before removing the Digger.

WARNING

Do not operate PTO when the angle created between the earth and the drive shaft exceeds 45 degrees. If the PTO shaft breaks or the universal joint fails, the PTO may rotate without support at both ends, resulting in personal injury and damage to the equipment.

CAUTION

Be sure auger is completely removed from hole before moving tractor.

REMOVING DIGGER continued

STEP 1

To remove the Digger from the tractor, disconnect the PTO shaft from the tractor by turning the twist collar. Remove PTO shaft from gearbox by removing the shear bolt and roll pin.

STEP 2

Remove the auger assembly by removing the nut and bolt holding it in the shaft.

STEP 3

Using the tractor hydraulics, lower the boom as low as it will go.

STEP 4

Remove the nut and bolt that hold the U-frame to the boom assembly mounting plate.

STEP 5

Hold up the boom with one hand and carefully swing the U-frame down to the ground with your other hand.

STEP 6

Lower the boom to the ground (with gearbox attached).

STEP 7

Remove the boom assembly and U-frame assembly from the three-point hitch on the tractor by removing the spring clips and pins.

STEP 8

Replace the protective guard back over the tractor's PTO shaft for safety and to keep dirt out and water.

STEP 9

Clean all mud and dirt from the auger before long term storage to prevent rust and corrosion. Store assembly if desired. Be sure all small parts and fasteners are kept together for convenient reassembly later.

MAINTENANCE SAFETY



Good maintenance is your responsibility.

- Follow good shop practices
- Keep service area clean and dry.
- Be sure electrical outlets and tools are properly grounded.
- Use adequate light for the job at hand.

Make sure there is ample ventilation. Never operate tractor engine in a closed building. The exhaust fumes may cause asphyxiation.

Before working on this machine, disengage the PTO, be certain all moving parts on attachments have come to a complete stop, shut off engine, set the park brakes and remove the ignition keys before attempting to perform maintenance.

Do not perform maintenance or work on the Post Hole Digger on uneven or sloping surfaces.

Never work under equipment unless Post Hole Digger is properly supported by blocks or stands under the body with appropriate approved weight capacity.

Always use personal protection devices such as eye, hand and hearing protectors when performing any service or maintenance.

Frequently tighten all bolts, nuts, screws and check to make certain unit is safe to operate. Cotter pins should be in place and bent over or flared out with pliers. The twist collar at the splined PTO union should be secure. The PTO shaft should be bolted with grade 2 bolt and roll pin inserted through the gearbox yoke.

Periodically lubricate the PTO shaft universal joints at the grease fittings.

When completing maintenance or service, make sure all safety guards and devices are installed before using the Post Hole Digger.

After servicing, be sure all tools, parts and service equipment are removed from the Post Hole Digger.

Do not allow debris, grease or oil to build up on any part of the deck or platform.

Where replacement parts are necessary for periodic maintenance and servicing, factory replacement parts must be used to restore your equipment to original specifications. Contact your local dealer or Southern Cross Ag Machinery regarding supply or replacement parts.

The manufacturer and / or distributor will not be responsible for injuries or damages caused by the use of unapproved parts and or accessories.

Be sure that no bolt longer than 2 1/2" is used for PTO connections. Be sure that no bolt longer than 3 1/2" is used at the auger / gearbox connection. Longer bolts will protrude, hitting the safety shield and causing a safety hazard.

A first aid kit should be kept readily accessible while performing maintenance on this equipment.

STORAGE SAFETY



Following use, or when unhooking the Post Hole Digger, disengage the PTO, stop the tractor, set the park brakes, shut off the engine and remove the ignition keys.

Store the unit in an area away from human activity.

Do not park equipment where it can be exposed to direct contact with livestock for long periods of time. Damage to Post Hole Digger and or livestock could result. Make sure all parked machines are on a hard, level surface and that all safety devices are engaged.



SAFETY DECAL LOCATIONS

The safety decals and their positions are shown on the illustration bellow. Good safety requires that you familiarize yourself with the various safety decals, the type of warning and the area or specific function related to that area that requires your SAFETY AWARENESS.

REMEMBER: If the safety decals have been removed or damaged new safety decals must be applied. Please contact Southern Cross Ag Machinery or your local dealer if you require new decals.

POST HOLE DIGGER SAFETY DECALS



Caution label
Located on boom.
Warns of dangers of operating PTO at speeds higher than 540 RPM.

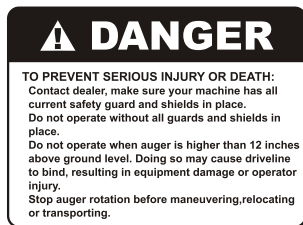

Danger label
Located on boom.
Warns of dangers of operating digger improperly.



Danger label
Located on auger assembly
Warns of dangers of operating digger without safety shield.



Danger label
Located on driveline under shield
Warns of dangers of operating digger without safety shield.

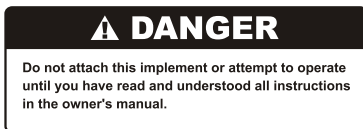

Danger label
Located on boom mounting plate.

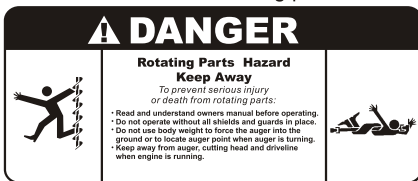

Danger label
Located on boom.
Warns of dangers of coming in contact with driveline and auger.



Danger label
Located on driveline.
Warns of dangers of rotating driveline

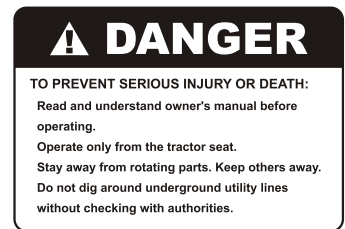

Danger label
Located on boom.
Warns of dangers of operating digger improperly.

MAINTENANCE SCHEDULE

Southern Cross Mowers recommends that the following routine service / maintenance schedule be followed to ensure the efficient and safe operation of your Post Hole Digger. If followed this maintenance schedule will maximise the working life of the Post Hole Digger.

PRIOR TO FIRST USE OF POST HOLE DIGGER

1. Check all bolts and nuts are tightened correctly
2. Check all hitch pins are securely locked
3. Check Bow Shackles on drag chains are tight
4. Ensure Quick Coupler Pins on the PTO shaft are secured correctly to both the Slip Clutch (Post Hole Digger end) and to the tractor PTO output shaft
5. Ensure slip clutch is set correctly
6. Check gearbox oil level. Add oil if required
7. Check PTO shaft has been greased as per instructions listed on bottom of this page.

AFTER FIRST THREE HOURS OF OPERATION

1. Check all bolts and nuts are tightened correctly
2. Check gearbox oil level. Add oil if required

AFTER EVERY EIGHT HOURS OF OPERATION

1. Grease PTO shaft as per instructions listed on bottom of this page.
2. Check Cutter Beam for any signs of damage and check Retaining Nut to gearbox is tight and split pin is still in place
3. Check blades for signs of damage or excessive wear. Replace if necessary
4. Ensure blade retaining plough bolts and self locking nuts are not damaged and are tight
5. Check Clutch settings and make adjustments if necessary
6. Check for any debris from cutting or items such as wire are not built up around gearbox output shaft and cutter beam
7. Clean Post Hole Digger deck and remove any cuttings or other debris that has built up on the Post Hole Digger. In heavy slashing conditions cuttings may need to be cleared from the deck more frequently.

AFTER EVERY 40 HOURS OF OPERATION

1. Complete all processes as per eight hour service
2. Check all bolts and nuts are tightened correctly
3. Check all hitch pins are securely locked
4. Check Bow Shackles on drag chains are tight
5. Check PTO shaft universal joints for any signs of wear. Replace any worn components if required

PTO SHAFT MAINTENANCE

PTO shaft universal joints and telescopic sections should be greased with a good quality high temperature grease similar to (MP) Multipurpose Chassis Grease every 20 hours for average conditions. In severe operating conditions grease should be added every eight hours.

Safety guard bearings should be lubricated by applying general purpose grease to the plastic grease nipples on the bell guards every 20 hours.

REPLACING BLADES

It is recommended that whenever blades require replacing on a Southern Cross Ag Machinery Post Hole Digger the following components also be replaced. Blade retainer bolts, nylock nuts, washers and hardened wearing collars bolts must be tightened to 350 ft. /lb. These are listed in the Parts List on pages 26-27 of this Manual. Specifications are also detailed and must be replaced using genuine Southern Cross Ag Machinery parts. Please contact your local dealer or Southern Cross Ag Machinery for any parts required.

TROUBLE SHOOTING GUIDE

PROBLEM	POSSIBLE CAUSE	POSSIBLE REMEDY
Leaves a streak of uncut or partially cut grass	1. Post Hole Digger not level side to side	Level 3pt. hitch linkage on tractor
	2. Blades dull or bent	Sharpen or replace blades
	3. Carrier speed too low	Use correct PTO speed
	4. Field conditions are so wet that the tractor tyre is pushing grass into mud.	Too wet to slash. Stop operation and wait for drier conditions
	5. Ground speed too fast	Reduce ground speed by shifting to a lower gear
	6. Blades lock back	Free blades
	7. Blades riding up due to blade bolt wear.	Replace blade bolts and hardened bushes'
	8. Grass is laying down from previous weather conditions.	Slash in only one direction
	9. Possible build up of material under Post Hole Digger	Clean Post Hole Digger
	10. Weed and grass stems are pushed down by the tractor tyres and do not rebound up so they can be cut	Slash back and forth with enough overlap to slash tyre track of previous cut again
Grass cut lower in centre swath than at edge	Height of Post Hole Digger lower at rear of front.	Adjust Post Hole Digger height and attitude so that Post Hole Digger rear and front are within 1/2" of same height
Gearbox overheating	1. Low on lubricant	Fill to proper level
	2. Improper type of lubricant	Replace with proper lubricant
	3. Excessive debris build-up	Remove debris around gearbox
Blade is scalping ground	1. Post Hole Digger too low	Raise Post Hole Digger and 3pt. control stop
	2. Field is too ridged	Cut field at a different angle
	3. Field is too wet	Stop and wait until it is drier
Post Hole Digger will not cut all the time	Slip clutch is slipping	Adjust slip clutch according to instructions
Post Hole Digger moves from side to side when cutting	Loose tractor sway chains, bars or sway blocks improperly installed	Adjust sway chains, bars or sway blocks
PTO contacts Post Hole Digger front frame when raised	Raising Post Hole Digger too high or incorrect adjustment of tractor top link	Adjust top link or tractor lift stops
Blade bolts come loose	1. Bolts not tightened	Tighten bolts to 350 ft. /lb
	2. Bolt hole elongated or oversized	Replace blade carrier
	3. Blade bolt threads are worn or damaged.	Replace blade bolt, washer, nylock nut and hardened bush
Blade wears too fast	1. Cutting in sandy conditions	Increase cutting height
	2. Cutting in rocky conditions	Increase cutting height
	3. Blades hitting ground	Increase cutting height

TROUBLE SHOOTING GUIDE continued

PROBLEM	POSSIBLE CAUSE	POSSIBLE REMEDY
Post Hole Digger seems to require excessive power	1. Advancing into grass or bush too rapidly	Reduce forward travel speed
	2. Hitting ground	Raise Post Hole Digger
	3. Worn or dull blades	Replace blades
	4. Tractor not large enough	Use higher horsepower tractor
Excessive vibration	1. Check gearbox bolts	Tighten if loose
	2. Check for loose nuts on all components	Tighten if loose
	3. Check for bent output Shaft, oil will normally leak from bottom seal	Replace shaft if bent
	4. Check to see if blades are free-swinging	Free blades so they swing
	5. Check for even wear on each blade tip. Were both blades changed at the same time?	Weigh blades. Weight should be within 30 grams. Always replace both blades.
	6. Blade broken	Replace blades in sets
	7. Blade beam bent or damaged	Replace blade beam
	8. New blade or bolts matched with worn blade or bolts.	Replace blades and bolts in sets
	9. Drivelines not phased correctly implement and tractor yokes must be in line.	Replace driveline
	10. Wire or rope wrapped around blade beam.	Remove wire or rope
	11. Blades worn and are out of balance.	Replace blades in sets
Gearbox Noisy	1. Rough gears	Run in or change gears
	2. Worn bearings	Replace bearing
	3. Low oil in gearbox	Check level and add oil.
Gearbox leaking (continued on following page)	1. Damaged oil seal	Replace seal
	2. Bent shaft	Replace oil seal and shaft
	3. Shaft rough on oil seal area	Replace or repair shaft
	4. Oil seal installed incorrectly	Replace seal and install correctly

TROUBLE SHOOTING GUIDE continued

PROBLEM	POSSIBLE CAUSE	POSSIBLE REMEDY
Gearbox leaking (continued)	5. Oil seal not sealing in the housing	Replace seal or use a sealant on outside diameter of seal
	6. Oil level too high	Drain oil to proper level
	7. Hole in gearbox	Replace gearbox
	8. Gasket damaged	Replace gasket
	9. Bolts loose	Tighten bolts
Front hitch "A" frame bending sideways	1. Operator turning sharply hitting objects with tail wheel frame or Post Hole Digger deck	Drive carefully and plan turns to avoid hitting buildings, posts, trees etc.
	2. Post Hole Digger is being operated too low and Post Hole Digger is contacting ground during turns.	A. Raise Post Hole Digger (especially on rough ground) B. Set stop on hitch controls lever so hitch lift arms do not drop Post Hole Digger on ground.
	3. Tractor 3pt. hitch leaking / creeping down and Post Hole Digger deck is contacting ground	A. Repair tractor hitch hydraulic system B. Use limit chains to keep arms from going lower than set limit.

POST HOLE DIGGER PARTS DIAGRAM & LIST

GEAR BOX & MOUNTING PIN

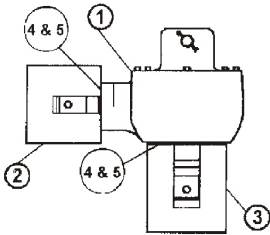

PART #	NAME	SIZE	# REQ'D
1	GEAR BOX ASSEMBLY		1
2	SAFETY SHIELD INPUT		1
3	SAFETY SHIELD OUTPUT		1
4	BOLT (grade 5)	5/16 x 3/4	4
5	LOCK WASHER	5/16	4

POWER TAKE OFF

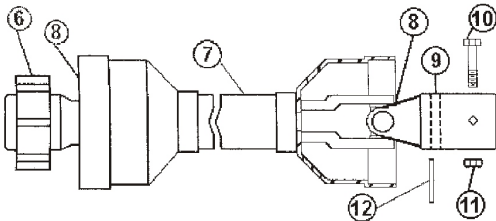

PART #	NAME	SIZE	# REQ'D
6	YOKE (tractor end)		1
7	PTO SHAFT ASSEMBLY		1
8	CROSS JOURNAL ASSEMBLY		2
9	YOKE (gear box end)		1
*10	SHEAR BOLT (grade 2)	3/8 x 2 1/2	1
*11	LOCKNUT	3/8 - 16	1
*12	ROLL PIN	5/16 X 1 1/2	1

BOOM ASSEMBLY

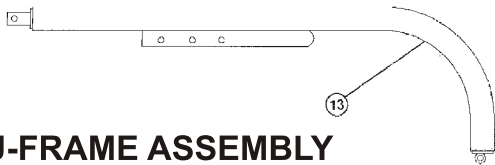

PART #	NAME	SIZE	# REQ'D
13	BOOM ASSEMBLY	2 7/8 PIPE	1

U-FRAME ASSEMBLY

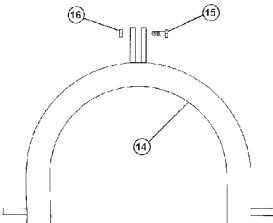

PART #	NAME	SIZE	# REQ'D
14	U-FRAME ASSEMBLY	2 7/8 PIPE	1
*15	BOLT	3/4 x 2 3/4	1
*16	LOCK NUT	3/4 - 10	1

AUGER ASSEMBLY

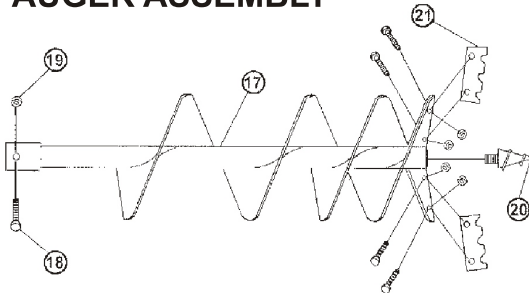

PART #	NAME	SIZE	# REQ'D
17	AUGER ASSEMBLY	6"	1
	AUGER ASSEMBLY	9"	1
	AUGER ASSEMBLY	12"	1
	AUGER ASSEMBLY	14"	1
*18	MOUNTING BOLT	1/2 x 3 1/2"	1
*19	FULL HEX NUT	1/2 - 13	1
20	SPIRAL POINT TIP	6", 9", 12" & 14"	1
21	CUTTING EDGES (weld on)	6"	1
	CUTTING EDGE KIT	9"	1
	CUTTING EDGE KIT	12"	1
	CUTTING EDGE KIT	14"	1

NOTE: * indicates item in parts bag



FOR FURTHER INFORMATION

WorkCover NSW

Visit www.workcover.nsw.gov.au

Call the WorkCover Assistance Service on **13 10 50**

Call the WorkCover Publications Hotline on **1300 799 003**

Visit your nearest WorkCover office.

For technical specifications on Post Hole Diggers, contact your local manufacturer.

SafeWork South Australia

GPO Box 465

Adelaide SA 5001

Help Centre: **1300 365 255**

Website: www.safework.sa.gov.au

Workplace Health and Safety Queensland, Department of Justice and Attorney-General

GPO Box 69

Brisbane QLD 4001

Workplace health and safety infoline: **1300 369 915**

Electrical Safety infoline: **1300 650 622**

Website: www.worksafe.qld.gov.au

WorkSafe Victoria

Advisory Service 222

Exhibition Street

Melbourne VIC 3000

Telephone: **03 9641 1444**

Toll free: **1800 136 089**

Email: info@worksafe.vic.gov.au

Website: www.worksafe.vic.gov.au

WorkSafe Western Australia

1260 Hay Street

West Perth WA 6005

Telephone: **08 9327 8777**

Toll Free: **1300 307 877**

Email: safety@commerce.wa.gov.au

Website: www.worksafe.wa.gov.au

Dial Before You Dig Queensland

State Manager - Paul Newman

433 Logan Road, Stones Corner QLD 4120

Ph: 07 3394 8374

Fax: 07 3394 4080

dbydq@bigpond.net.au

Dial Before You Dig NSW/ACT Inc

State Manager - Dominic Puiu

PO Box 1927, Bondi Junction NSW 1355

Ph: 0418 500 155

Fax: 02 9386 4461

dpuiu@bigpond.com

FOR FURTHER INFORMATION continued

Dial Before You Dig Vic/Tas

State Manager - Mark Binks
35 Railway Road, Blackburn VIC 3130
Ph: 03 9259 0100
Fax: 03 9877 0438
support@1100.com.au

Dial Before You Dig SA/NT Inc

State Manager - Nigel March
PO Box 1199
Unley Business Centre SA 5061
Ph: 08 8274 3708
Fax: 08 8274 3764
nmarch@dialbeforeyoudig.com.au

Dial Before You Dig WA Ltd

State Manager – Kim Rushton
13 South Street Canning Vale WA 6155
Ph: 08 9424 8116
Fax: 08 9424 8122
kim@dialbeforeyoudig.com.au



WARRANTY

Southern Cross Ag Machinery warrants all their products against defective workmanship and, or materials for a period of twelve (12) months from the date of purchase. A three-year extended warranty program applies to gearboxes supplied with the following products; Post Hole Diggers, finishing mowers and post-hole diggers sold from June 25th 2009. For attachments used in commercial enterprises the Warranty period is six (6) months on all components with the exception of components that are not included as per the detailed listed in the next paragraph. Proof of purchase plus proof of the defect will be required and must be received by Southern Cross Ag Machinery within seven days of product failure and prior to the end of the twelve (12) month period from date of purchase. A *Warranty Claim Form* MUST be lodged through the Dealer where the item was purchased. A *Warranty Claim Number* will be issued. Work commenced without a Claim Number issued and therefore warranty approval will not be covered by Southern Cross Ag Machinery.

Southern Cross Ag Machinery takes no responsibility for the repair of any products rendered defective or damaged through normal wear and tear or incorrect use of the product. Southern Cross Ag Machinery does not provide warranty on any cutting blades, tilling / hoe blades, rippers, scarifiers, tynes, tyres, clutch plates, friction plates, V-belts and Post Hole Digger cutting bits. Southern Cross Ag Machinery does not provide warranty on any products that have undergone modification. Southern Cross Ag Machinery reserves the right to determine whether the product is defective. Southern Cross Ag Machinery does not accept responsibility for any product which is damaged in transit. Faulty parts may need to be returned to Southern Cross Ag Machinery as part of the Warranty process. Freight costs each way will be paid by the owner / purchaser of the product.

Purchasers, dealers or agents of the Southern Cross Ag Machinery product are not authorised to give warranty on behalf of Southern Cross Ag Machinery. Claims will only be recognised, if lodged as outlined on page 29 in the *Warranty Process*. Any work commenced without Southern Cross Ag Machinery approval will not be honoured.

Product specifications are subject to change due to our company's policy of improvement. Design changes and improvements maybe made by Southern Cross Ag Machinery whenever it believes the effectiveness of its products can be improved. Southern Cross Ag Machinery has no obligation to incorporate any improvements to products, which are currently in service or have been supplied.

REGISTER YOUR WARRANTY

To register your Warranty please ensure the dealer from where the product has been purchased completes the *Southern Cross Ag Machinery Installation / Warranty Registration* Form. This triplet document needs to be signed by the purchaser. One copy remains with the Dealer, one copy needs to be mailed to Southern Cross Ag Machinery (PO Box 454, Rutherford NSW 2320) and one copy will remain with the purchaser for your reference.

If you have any queries regarding the warranty of your Southern Cross Ag Machinery product please call our office Tel. (02) 4932 3011 or email sales@sxm.com.au.

WARRANTY PROCESS

1. Contact your dealer or point of purchase who will contact Southern Cross Ag Machinery.
2. Photos and or video footage may be required to process your claim with a short description of the problem. This will be lodged through your dealer or point of purchase by the completion of the Southern Cross Ag Machinery *Warranty Claim Form*.
3. The claim will be assessed by Southern Cross Ag Machinery to determine whether the warranty claim will be approved. This can take up to five working days from when Southern Cross Ag Machinery is first notified of the problem and proof of product failure along with *Warranty Claim Form* is supplied.
4. If the *Warranty Claim* is approved a *Warranty Claim Number* will be issued to the Dealer.
5. Any work commenced without approval from Southern Cross Ag Machinery and without a *Warranty Claim Number* will not be covered by Warranty. Repairs must be made by Southern Cross Ag Machinery or an authorised dealer. Southern Cross Ag Machinery reserves the exclusive right to determine whether it will pay labour costs for warranty repairs or replacements and the amount of such costs that it will pay and the time in which the repairs will be made. Southern Cross Ag Machinery will not approve invoices sent for repairs that Southern Cross Ag Machinery has not previously approved.
6. Travel and freight charges associated with the processing of the Warranty Claim will not be covered by the Southern Cross Ag Machinery Warranty and is the responsibility of the owner / purchaser.

DISCLAIMER

Whilst information is true at time of printing actual product may differ slightly from the product described herein due to our company's policy of improvement. Errors and omissions may happen from time to time, we apologise for any inconvenience should this occur. Products may differ slightly in appearance to illustrations / photographs provided.

SOUTHERN CROSS AG MACHINERY
1/29 MUSTANG DRIVE, RUTHERFORD NSW 2320
PO BOX 454. RUTHERFORD NSW 2320

T. 02 4932 3011

WWW.SXM.COM.AU

AUTHORISED SXM DEALER

